



AP Dynamometer Specifications

Pound Capacities

| 5" (125mm) Dial Size | | 10" (250 mm) Dial Size | | Ultimate Safety Factor | |
|----------------------|----------------------------|------------------------|----------------------------|------------------------|-------|
| <u>Part number</u> | <u>Cap x division size</u> | <u>Part number</u> | <u>Cap x division size</u> | | |
| LOW | 30006-0019 | 500 x 5 | 30007-0018 | 500 x 2 | 5:1 |
| | 30006-0027 | 1,000 x 10 | 30007-0026 | 1,000 x 5 | 5:1 |
| | 30006-0035 | 2,000 x 20 | 30007-0034 | 2,000 x 10 | 5:1 |
| | 30006-0043 | 4,000 x 25 | 30007-0042 | 4,000 x 20 | 5:1 |
| | 30006-0050 | 5,000 x 50 | 30007-0059 | 5,000 x 20 | 5:1 |
| | 30006-0068 | 6,000 x 50 | 30007-0067 | 6,000 x 25 | 5:1 |
| | 30006-0076 | 8,000 x 50 | 30007-0075 | 8,000 x 50 | 5:1 |
| | 30006-0084 | 10,000 x 100 | 30007-0083 | 10,000 x 50 | 5:1 |
| MED | 30006-0092 | 15,000 x 100 | 30007-0091 | 15,000 x 100 | 5:1 |
| | 30006-0100 | 20,000 x 200 | 30007-0109 | 20,000 x 100 | 4.5:1 |
| HIGH | | 30784-0017 | 30,000 x 200 | 5:1 | |
| | | 30784-0025 | 40,000 x 200 | 4:1 | |
| | | 30784-0033 | 50,000 x 200 | 3:1 | |
| | | 30332-0014 | 100,000 x 500 | 4:1 | |

Kilogram Capacities

| 5" (125mm) Dial size | | 10" (250mm) Dial size | | Ultimate Safety Factor | |
|----------------------|----------------------------|-----------------------|----------------------------|------------------------|-------------|
| <u>Part number</u> | <u>Cap x division size</u> | <u>Part number</u> | <u>Cap x division size</u> | | |
| LOW | 30006-0142 | 200 x 2 | 30007-0141 | 200 x 1 | 5:1 |
| | 30006-0134 | 500 x 5 | 30007-0133 | 500 x 2 | 5:1 |
| | 30006-0159 | 1,000 x 10 | 30007-0158 | 1,000 x 5 | 5:1 |
| | 30006-0126 | 2,000 x 20 | 30007-0125 | 2,000 x 10 | 5:1 |
| | 30006-0167 | 4,000 x 25 | 30007-0166 | 4,000 x 20 | 5:1 |
| | 30006-0175 | 5,000 x 50 | 30007-0174 | 5,000 x 20 | 5:1 |
| | MED | 30006-0118 | 10,000 x 100 | 30007-0117 | 10,000 x 50 |
| HIGH | | 30784-0041 | 15,000 x 100 | 5:1 | |
| | | 30784-0058 | 20,000 x 100 | 4:1 | |
| | | 30332-0022 | 50,000 x 200 | 4:1 | |

Model AP Dynamometer Dimensions

Dimensions in inches (mm)
 Drawing scales differ between capacities
 Dimensions subject to manufacturer /supplier tolerances and
 are subject to change without notice.

Low & Medium Capacities 500-20,000lb / 200-10,000kg

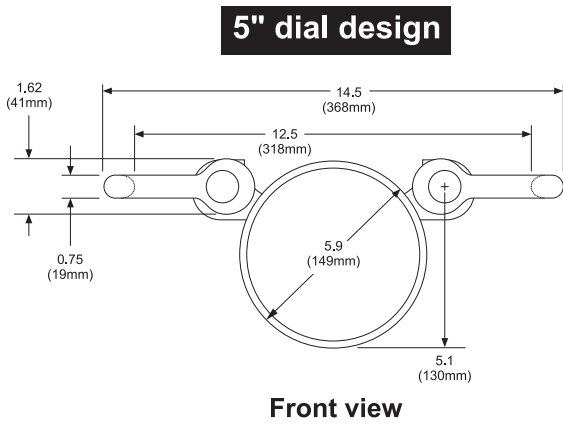

10" dial design

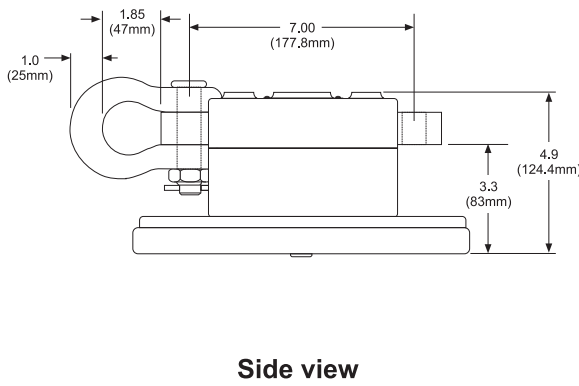
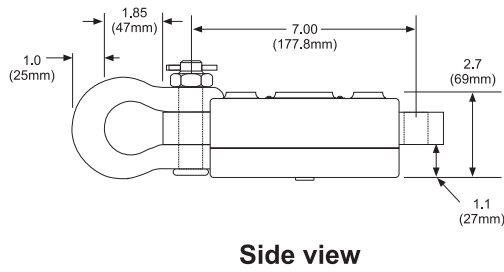
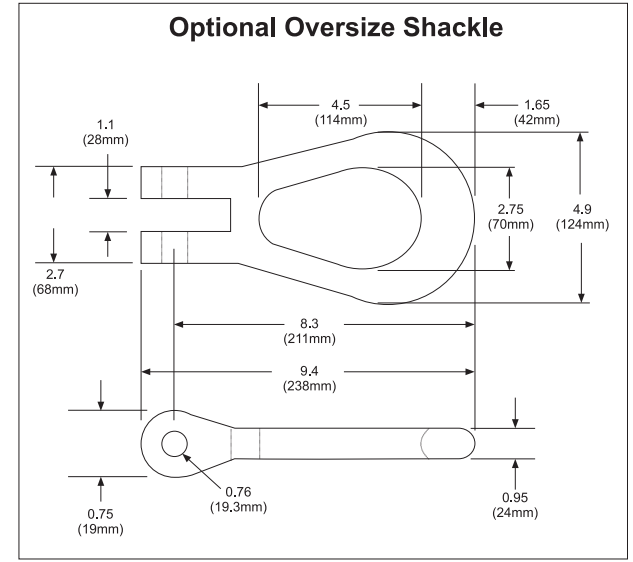
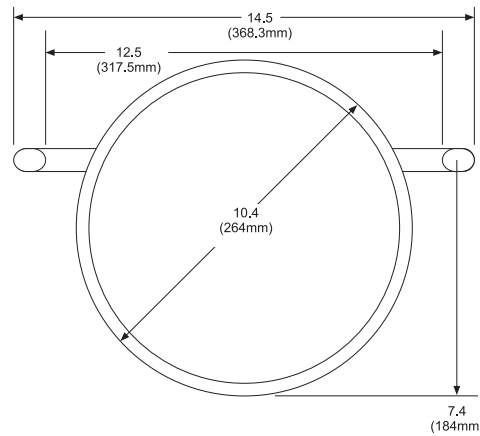

Standard Shackle

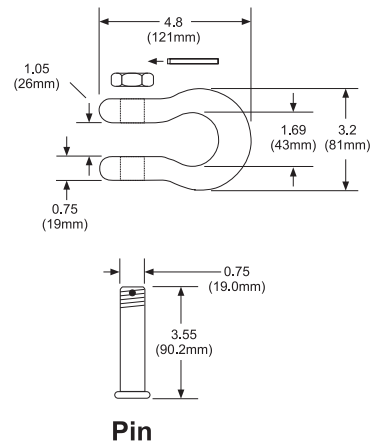

High Capacities 30,000-50,000lb / 15,000-20,000kg

For smaller, lighter and/or anchor shackles see Dillon APxtreme.

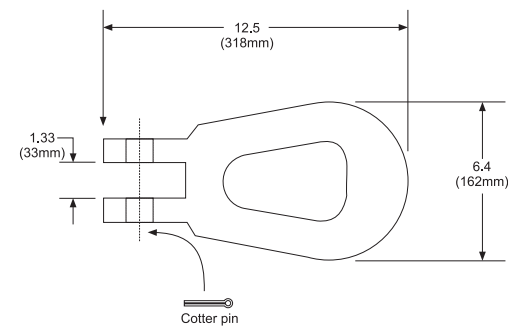
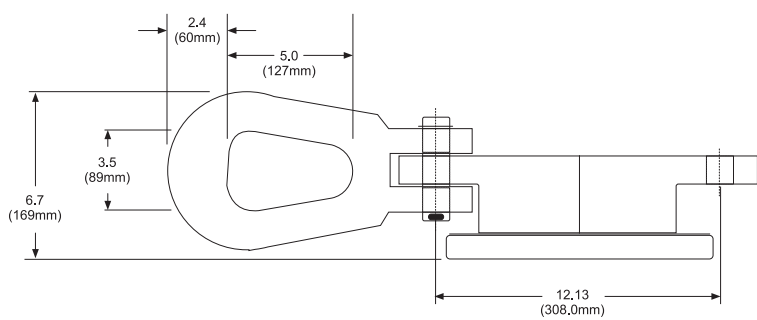
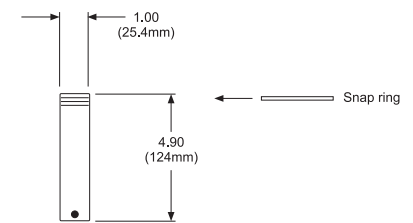
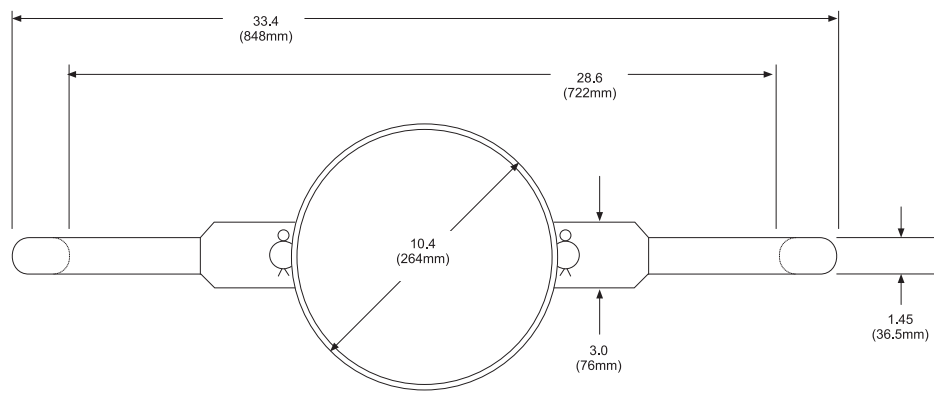

High Capacities 100,000lb / 50,000kg

For smaller, lighter and/or anchor shackles see Dillon APxtreme.

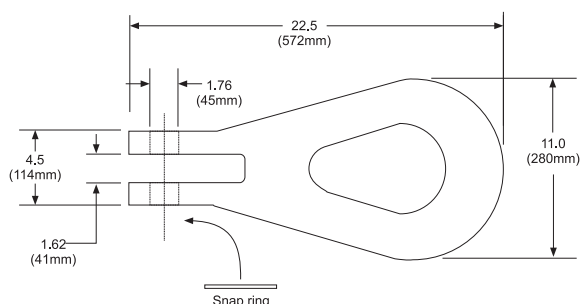
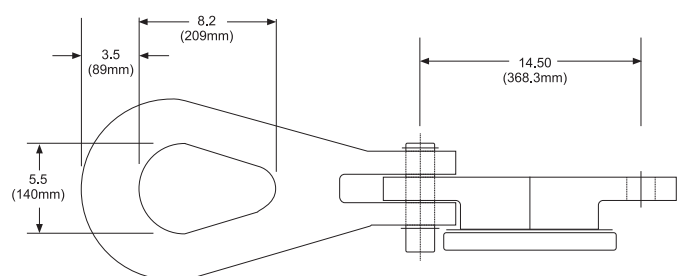
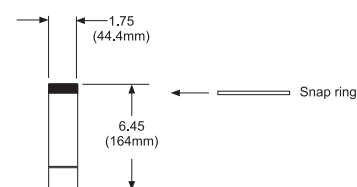
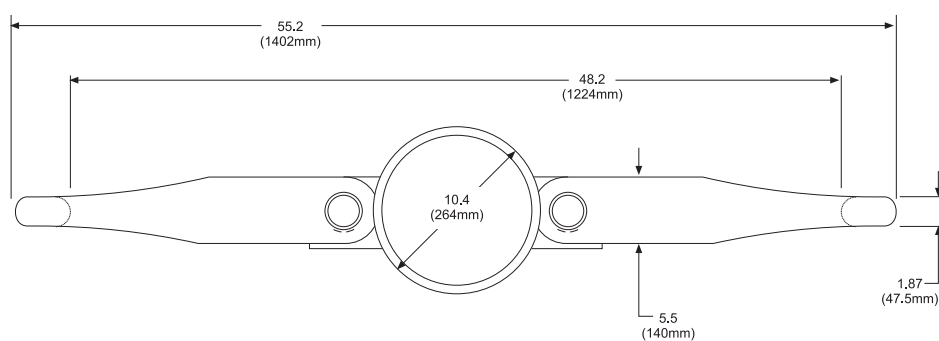

Model AP Mechanical Dynamometer Specifications

Accuracy: $\pm 0.5\%$ of capacity

Temperature range: -50° to 140° F (-45° to 60° C)

Ultimate Safety Factor:

See table on cover for minimum USF

Construction:

Pressure bar—

High-grade E4340 alloy steel or 7075-T651 aluminum

Shackles –

A4140 forged steel (machined from E4340 steel)

Shackle pins –

Machined from E4340 steel

Case housing:

5" models are equipped with high strength composite plastic case.

10" models use cast aluminum enclosure.

Corrosion protection: Pressure bar protected with durable powder coat paint. Shackles and pins are electroless nickel plated. All integral machining and fasteners are produced from noncorrosive materials or have suitable plating.

Zero control: Zero up to 20% of capacity. Zeroed load must be considered as part of ultimate load.

Calibration: Traceable to NIST.

Documentation: Includes User's Guide and signed calibration card.

Carry case/crate:

Low/Med capacity 5" dial – includes plastic carry case

Low/Med capacity 10" dial – optional steel carry case

All high capacity – includes reinforced plywood crate

Periodic proof loads: Controlled 150% proof loads permitted annually.

Shipping and packing (approximate weights):

5" Low and Med capacities

| | |
|-----------------|----------------|
| Net weight | 9 lb |
| Shipping weight | 15 lb |
| Shipping box | 16" x 11" x 7" |

10" Low and Med capacities

| | |
|-----------------|----------------|
| Net weight | 16 lb |
| Shipping weight | 26 lb |
| Shipping box | 14" x 14" x 7" |

30,000 – 50,000 lb (15,000 – 20,000 kg) High capacity

| | |
|-----------------|---------------------|
| Net weight | 64 lb |
| Shipping weight | 98 lb |
| Shipping crate | 37.5" x 13" x 10.5" |

100,000 lb (50,000 kg) High capacity

| | |
|-----------------|---|
| Net weight | 226 lb |
| Shipping weight | 315 lb |
| Shipping crates | 22.5" x 12.5" x 8" 26" x 13" x 9" (2 included) |



AUTHORIZED DISTRIBUTORS

FREDRICK-SHELTON & ASSOCIATES, INC.

5044 B.U. Bowman Drive, Suite 103

Buford, GA 30518-5869

Phone: 770-945-6262

Fax: 770-945-8585

Toll-Free Phone: 888-928-3758

<http://dillonga.com/>

DILLON

